

Table of Contents

Heavy Duty Fasteners

F-911 Fasteners Introduction	2
F-911 Fasteners Specifications	2
F-911 Fasteners Torque Chart	3
Cap Screws - F-911 Alloy Hex Head, Coarse	4-9
Assortments, Coarse	10
Cap Screws - F-911 Alloy Hex Head, Fine	11-16
Assortments, Fine	17
Cap Screw Assortments, Machinist	18
Hex Nuts - F-911 Alloy / USS and SAE.....	19
Flat Washers / USS and SAE - F-911 Alloy.....	20
Lock Washers - F-911 Alloy.....	21
Alloy Lock Nuts	21
Direct-Lock Washers and Hex Nut Assortment	22-23
Nylon Lock Nuts, USS and SAE	24
Plow Screw Hex Nuts (Heavy/Black)	24
Plow Screws - F-911 Alloy Dome Head.....	25
Shaker Screen Screws - F-911 Alloy Dome Head	26
Alloy Hex Keys.....	26
Socket Head Cap Screws - Alloy	27-29
Socket Flat Head Cap Screws - Alloy	30-31
Set Screws - Alloy Hex, Cup Point	31-33
Assortments	33
Carriage Bolts, Round Head, Square Neck.....	34

GARD F-911 Alloy Heavy Duty Fasteners

The Fastener of the Future



GARDs F-911 is the state-of-the-art in fastener technology, manufactured with methods usually reserved for only the most critical and special of fasteners, outdating all Grade 8 cap screw foreign and domestic. A high alloy fastener, GARDs F-911 encompasses the present and future quality demands of sophisticated manufacturing machinery and methods. Made in the USA, GARDs F-911 is a program which offers a guarantee of superior quality, completely tested, certified and traceable stock, so you know exactly what you are getting, with predictable results.

All F-911 fasteners (Hex Head Cap Screw, Shaker Screen Screws, and Plow Bolts), are manufactured under stringent quality control procedures. Only the most modern methods of metallurgy and heat treating are used, resulting in an incredibly high strength with maximum ductility and toughness; at a price that's competitive with lesser grade standard fasteners.

A fastener may seem like a small part of your project; but whether it's a combine or a missile silo, a sin-

gle failure could spell disaster. So how do you know the fasteners you buy will do the job? You don't!

Unless, of course, you specify GARDs F-911 fasteners. GARD offers a 180,000 psi minimum yield F-911 compared to 150,000 psi for Grade 8 cap screws. Each and every F-911 is tested for strength and integrity. When you specify GARDs F-911, you're getting more than a fastener, you're getting peace of mind.

We'd like to prove to you that the F-911 is an exceptional fastener. Contact your representative or GARDs corporate office for a free comparison of your current fastener with the F-911. We'll conduct a fastener-to-fastener test in your facility at your convenience.

You'll see why GARD's F-911 excels in all applications where strength and reliability are factors, versatility and safety is imperative, and cost savings are absolutely essential.

If these are your goals, GARD's F-911 is in your future.

GARD F-911 Technical Specifications

Dimensions: ANSI B18.2.1 with the exception of head height which is approximately 30% higher than standard. These dimensions are tabulated in the Industrial Fasteners, Institute Bolt, Nut and Rivet Standards.

Threads: Class 2A to ANSI B1.1

Raw Materials: 8640

Product Hardness: Rockwell C 38/42

Wedge Tensile Strength: 180,000 psi minimum for all sizes using a 6° wedge on bolts 1/4" through 3/4" diameter and 4° on 7/8" through 3/4" diameter bolts.

Proof Load: 140,650 psi

Yield Strength: 159,500 psi

Elongation: 8% minimum

Reduction in Area: 35% Minimum

Minimum Tempering: 716°F

Decarburization: SAE J-121

Discontinuities: SAE J-1061

Headmark: F-911 and a circular pattern on nine dots.

Mechanical Testing: ASTM F-606

Finish: Gold dichromate per QQ-Z-325 Type 2 Class 3 baked 3 hours at 375°F immediately after plating, not to be less than .0002" thickness.



2 HEAVY DUTY FASTENERS

Clamp Load Specifications

Suggested Torque Values ±5% to Produce Corresponding Clamp Loads

SIZE	Grade 2			Grade 5			Grade 8			GARD F-911		
	Clamp Load	Assembly Torque		Clamp Load	Assembly Torque		Clamp Load	Assembly Torque		Clamp Load	Assembly Torque	
	(LBS)	DRY Ft. Lbs.	LUB. Ft. Lbs.	(LBS)	DRY Ft. Lbs.	LUB. Ft. Lbs.	(LBS)	DRY Ft. Lbs.	LUB. Ft. Lbs.	(LBS)	DRY Ft. Lbs.	LUB. Ft. Lbs.
1/4-20	1320	66*	49*	2020	8	75*	2860	12	9	4450	12	9
1/4-28	1500	76*	56*	2320	10	86*	3280	14	10	5100	14	10
5/16-18	2160	11	8	3340	17	13	4720	25	18	7350	25	18
5/16-24	2400	12	9	3700	19	14	5250	25	20	8100	25	20
3/8-16	3200	20	15	4940	30	23	7000	45	35	10850	45	35
3/8-24	3620	23	17	5600	35	25	7900	50	35	12300	50	35
7/16-14	4380	30	24	6800	50	35	9550	70	55	14900	70	55
7/16-20	4900	35	25	7550	55	40	10700	80	60	16600	80	60
1/2-13	5840	50	35	9050	75	55	12750	110	80	19850	110	80
1/2-20	6600	55	40	10700	90	65	14400	120	90	22400	120	90
9/16-12	7100	65	50	11600	110	80	16400	150	110	25500	150	110
9/16-18	7900	75	55	12950	120	90	18250	170	130	28400	170	130
5/8-11	8800	90	70	14400	150	110	20350	220	170	31650	220	170
5/8-18	10000	100	80	16950	180	130	23000	240	180	35850	240	180
3/4-10	13000	160	120	21300	260	200	30100	380	280	46750	380	280
3/4-16	14550	180	140	23800	300	220	33600	420	320	52200	420	320
7/8-9	9700	140	110	27000	400	300	41600	600	460	64700	500	460
7/8-14	10700	155	120	29800	440	320	45800	660	500	71250	660	500
1"-8	12700	220	160	35500	580	440	54500	900	680	84850	900	680
1"-14	13900	240	170	38800	640	480	59700	1000	740	92800	1000	740
1-1/8-7	16000	300	220	42300	800	600	68700	1280	960	10680	1280	960
1-1/8-12	18000	340	260	47500	880	660	77000	1440	1080	119850	1440	1080
1-1/4-7	20350	420	320	53800	1120	840	87200	1820	1360	135650	1820	1360
1-1/4-12	22550	460	360	59600	1240	920	96600	2000	1500	150200	2000	1500
1-1/2-6	29800	740	560	78000	1940	1460	126500	3160	2360	196700	3160	2360
1-1/2-12	33200	840	620	87700	2200	1640	142200	3560	2660	221300	3560	2660

* Inch Lbs.

"Lubricated" includes lubricants, lubricizing, plating, hardened washers

GARD Quality Assurance

Each package lists a tracking number

GARD Specialists Co.
(PH)800-541-9301 (FAX)715-479-9269

PT. NO: 1-420-24
DESC : F-911 ALLOY CAP SCREW
SIZE : 1/4"-20 X 1-1/2" #12345
QTY : 100

GARD F-911 Alloy "Coarse" Cap Screws Hex Head / USS



1/4 - 20 Coarse

Length	Part No.	Pkg
1/2"	1-420-08	100
5/8"	1-420-10	100
3/4"	1-420-12	100
7/8"	1-420-14	100
1"	1-420-16	100
1-1/4"	1-420-20	100
1-1/2"	1-420-24	100
1-3/4"	1-420-28	100
2"	1-420-32	100
2-1/4"	1-420-36	100
2-1/2"	1-420-0	100
2-3/4"	1-420-44	100
3"	1-420-48	100
3-1/4"	1-420-52	50
3-1/2"	1-420-56	50
3-3/4"	1-420-60	50
4"	1-420-64	50
4-1/2"	1-420-72	1
5"	1-420-80	1
5-1/2"	1-420-88	1
6"	1-420-96	1
6-1/2"	1-420-104	1
7"	1-420-112	1
7-1/2"	1-420-120	1
8"	1-420-128	1

5/16 - 18 Coarse

Length	Part No.	Pkg
1/2"	1-518-08	100
5/8"	1-518-10	100
3/4"	1-518-12	100
7/8"	1-518-14	100
1"	1-518-16	100
1-1/4"	1-518-20	100
1-1/2"	1-518-24	100
1-3/4"	1-518-28	100
2"	1-518-32	100
2-1/4"	1-518-36	100
2-1/2"	1-518-40	100
2-3/4"	1-518-44	100
3"	1-518-48	100
3-1/4"	1-518-52	50
3-1/2"	1-518-56	50
3-3/4"	1-518-60	50
4"	1-518-64	50
4-1/2"	1-518-72	1
5"	1-518-80	1
5-1/2"	1-518-88	1
6"	1-518-96	1
6-1/2"	1-518-104	1
7"	1-518-112	1
7-1/2"	1-518-120	1
8"	1-518-128	1

GARD F-911 Alloy "Coarse" Cap Screws Hex Head / USS



3/8 - 16 Coarse

Length	Part No.	Pkg
1/2"	1-616-08	100
5/8"	1-616-10	100
3/4"	1-616-2	100
7/8"	1-616-14	100
1"	1-616-16	100
1-1/4"	1-616-20	100
1-1/2"	1-616-24	100
1-3/4"	1-616-28	100
2"	1-616-32	100
2-1/4"	1-616-36	100
2-1/2"	1-616-40	100
2-3/4"	1-616-44	100
3"	1-616-48	100
3-1/4"	1-616-52	50
3-1/2"	1-616-56	50
3-3/4"	1-616-60	50
4"	1-616-64	50
4-1/2"	1-616-72	1
5"	1-616-80	1
5-1/2"	1-616-88	1
6"	1-616-96	1
6-1/2"	1-616-104	1
7"	1-616-112	1
7-1/2"	1-616-120	1
8"	1-616-128	1

7/16 - 14 Coarse

Length	Part No.	Pkg
3/4"	1-714-12	100
7/8"	1-714-14	100
1"	1-714-16	100
1-1/4"	1-714-20	50
1-1/2"	1-714-24	50
1-3/4"	1-714-28	50
2"	1-714-32	50
2-1/4"	1-714-36	50
2-1/2"	1-714-40	50
2-3/4"	1-714-44	50
3"	1-714-48	50
3-1/4"	1-714-52	25
3-1/2"	1-714-56	25
3-3/4"	1-714-60	25
4"	1-714-64	25
4-1/2"	1-714-72	1
5"	1-714-80	1
5-1/2"	1-714-88	1
6"	1-714-96	1
6-1/2"	1-714-104	1
7"	1-714-112	1
7-1/2"	1-714-120	1
8"	1-714-128	1

GARD F-911 Alloy "Coarse" Cap Screws Hex Head / USS



1/2 - 13 Coarse

Length	Part No.	Pkg
3/4"	1-813-12	50
1"	1-813-16	50
1-1/4"	1-813-20	50
1-1/2"	1-813-24	50
1-3/4"	1-813-28	50
2"	1-813-32	50
2-1/4"	1-813-36	50
2-1/2"	1-813-40	50
2-3/4"	1-813-44	50
3"	1-813-48	50
3-1/4"	1-813-52	25
3-1/2"	1-813-56	25
3-3/4"	1-813-60	25
4"	1-813-64	25
4-1/2"	1-813-72	1
5"	1-813-80	1
5-1/2"	1-813-88	1
6"	1-813-96	1
6-1/2"	1-813-104	1
7"	1-813-112	1
7-1/2"	1-813-120	1
8"	1-813-128	1

9/16 - 12 Coarse

Length	Part No.	Pkg
1"	1-912-16	25
1-1/4"	1-912-20	25
1-1/2"	1-912-24	25
1-3/4"	1-912-28	25
2"	1-912-32	25
2-1/4"	1-912-36	25
2-1/2"	1-912-40	25
2-3/4"	1-912-44	25
3"	1-912-48	25
3-1/4"	1-912-52	25
3-1/2"	1-912-56	25
3-3/4"	1-912-60	25
4"	1-912-64	25
4-1/2"	1-912-72	1
5"	1-912-80	1
5-1/2"	1-912-88	1
6"	1-912-96	1
6-1/2"	1-912-104	1
7"	1-912-112	1
7-1/2"	1-912-120	1
8"	1-912-128	1

GARD F-911 Alloy “Coarse” Cap Screws Hex Head / USS



5/8 - 11 Coarse

Length	Part No.	Pkg
1"	1-1011-16	25
1-1/4"	1-1011-20	25
1-1/2"	1-1011-24	25
1-3/4"	1-1011-28	25
2"	1-1011-32	25
2-1/4"	1-1011-36	25
2-1/2"	1-1011-40	25
2-3/4"	1-1011-44	25
3"	1-1011-48	25
3-1/4"	1-1011-52	25
3-1/2"	1-1011-56	25
3-3/4"	1-1011-60	25
4"	1-1011-64	25
4-1/2"	1-1011-72	1
5"	1-1011-80	1
5-1/2"	1-1011-88	1
6"	1-1011-96	1
6-1/2"	1-1011-104	1
7"	1-1011-112	1
7-1/2"	1-1011-120	1
8"	1-1011-128	1
8-1/2"	1-1011-136	1
9"	1-1011-144	1
9-1/2"	1-1011-152	1
10"	1-1011-160	1

3/4 - 10 Coarse

Length	Part No.	Pkg
1"	1-1210-16	20
1-1/4"	1-1210-20	20
1-1/2"	1-1210-24	20
1-3/4"	1-1210-28	20
2"	1-1210-32	20
2-1/4"	1-1210-36	20
2-1/2"	1-1210-40	20
2-3/4"	1-1210-44	20
3"	1-1210-48	20
3-1/4"	1-1210-52	20
3-1/2"	1-1210-56	20
3-3/4"	1-1210-60	20
4"	1-1210-64	20
4-1/2"	1-1210-72	1
5"	1-1210-80	1
5-1/2"	1-1210-88	1
6"	1-1210-96	1
6-1/2"	1-1210-104	1
7"	1-1210-112	1
7-1/2"	1-1210-120	1
8"	1-1210-128	1
8-1/2"	1-1210-136	1
9"	1-1210-144	1
9-1/2"	1-1210-152	1
10"	1-1210-160	1

GARD F-911 Alloy "Coarse" Cap Screws Hex Head / USS



7/8 - 9 Coarse

Length	Part No.	Pkg
1-1/2"	1-1409-24	1
1-3/4"	1-1409-28	1
2"	1-1409-32	1
2-1/4"	1-1409-36	1
2-1/2"	1-1409-40	1
2-3/4"	1-1409-44	1
3"	1-1409-48	1
3-1/4"	1-1409-52	1
3-1/2"	1-1409-56	1
3-3/4"	1-1409-60	1
4"	1-1409-64	1
4-1/2"	1-1409-72	1
5"	1-1409-80	1
5-1/2"	1-1409-88	1
6"	1-1409-96	1
6-1/2"	1-1409-104	1
7"	1-1409-112	1
7-1/2"	1-1409-120	1
8"	1-1409-128	1
8-1/2"	1-1409-136	1
9"	1-1409-44	1
9-1/2"	1-1409-152	1
10"	1-1409-160	1

1" - 8 Coarse

Length	Part No.	Qty
1-1/2"	1-1608-24	1
1-3/4"	1-1608-28	1
2"	1-1608-32	1
2-1/4"	1-1608-36	1
2-1/2"	1-1608-40	1
2-3/4"	1-1608-44	1
3"	1-1608-48	1
3-1/4"	1-1608-52	1
3-1/2"	1-1608-56	1
3-3/4"	1-1608-60	1
4"	1-1608-64	1
4-1/2"	1-1608-72	1
5"	1-1608-80	1
5-1/2"	1-1608-88	1
6"	1-1608-96	1
6-1/2"	1-1608-104	1
7"	1-1608-112	1
7-1/2"	1-1608-120	1
8"	1-1608-128	1
8-1/2"	1-1608-136	1
9"	1-1608-144	1
9-1/2"	1-1608-152	1
10"	1-1608-160	1

GARD F-911 Alloy "Coarse" Cap Screws Hex Head / USS



1-1/8" - 7 Coarse

Length	Part No.	Qty
2"	1-1807-32	1
2-1/4"	1-1807-36	1
2-1/2"	1-1807-40	1
2-3/4"	1-1807-44	1
3"	1-1807-48	1
3-1/4"	1-1807-52	1
3-1/2"	1-1807-56	1
3-3/4"	1-1807-60	1
4"	1-1807-64	1
4-1/2"	1-1807-72	1
5"	1-1807-80	1
5-1/2"	1-1807-88	1
6"	1-1807-96	1
6-1/2"	1-1807-104	1
7"	1-1807-112	1
7-1/2"	1-1807-120	1
8"	1-1807-128	1
8-1/2"	1-1807-136	1
9"	1-1807-144	1
9-1/2"	1-1807-152	1
10"	1-1807-160	1

1-1/4" - 7 Coarse

Length	Part No.	Qty
2"	1-2007-32	1
2-1/4"	1-2007-36	1
2-1/2"	1-2007-40	1
2-3/4"	1-2007-44	1
3"	1-2007-48	1
3-1/4"	1-2007-52	1
3-1/2"	1-2007-56	1
3-3/4"	1-2007-60	1
4"	1-2007-64	1
4-1/2"	1-2007-72	1
5"	1-2007-80	1
5-1/2"	1-2007-88	1
6"	1-2007-96	1
6-1/2"	1-2007-104	1
7"	1-2007-112	1
7-1/2"	1-2007-120	1
8"	1-2007-128	1
8-1/2"	1-2007-136	1
9"	1-2007-144	1
9-1/2"	1-2007-152	1
10"	1-2007-160	1

GARD (USS) F-911 Cap Screw Assortment

2,897 Piece Total including 2 Steel Bins

1/4" thru 3/4" / Coarse Thread / Part Number: 500-1C

F-911 Alloy Hex Nuts and Flat Washers													
1/4"	Qty.	5/16"	Qty.	3/8"	Qty.	7/16"	Qty.	1/2"	Qty.	5/8"	Qty.	3/4"	Qty.
1/4-20 Hex Nut	100	5/16-18 Hex Nut	100	3/8-16 Hex Nut	100	7/16-14 Hex Nut	50	1/2-13 Hex Nut	50	5/8-11 Hex Nut	25	3/4-10 Hex Nut	25
1/4" Flatwasher	250	5/16" Flatwasher	200	3/8" Flatwasher	200	7/16" Flatwasher	100	1/2" Flatwasher	100	5/8" Flatwasher	50	3/4" Flatwasher	50

F-911 Cap Screws													
1/4-20 x	Qty.	5/16-18 x	Qty.	3/8-16 x	Qty.	7/16-14 x	Qty.	1/2-13 x	Qty.	5/8-11 x	Qty.	3/4-10 x	Qty.
1/2"	100	1/2"	50	3/4"	25	1"	12	1"	12	1-1/2"	12	1-1/2"	6
3/4"	100	3/4"	50	1"	25	1-1/4"	12	1-1/4"	12	1-3/4"	12	1-3/4"	6
1"	50	1"	50	1-1/4"	25	1-1/2"	12	1-1/2"	12	2"	12	2"	6
1-1/4"	50	1-1/4"	25	1-1/2"	25	1-3/4"	12	1-3/4"	12	2-1/4"	12	2-1/4"	6
1-1/2"	50	1-1/2"	25	1-3/4"	25	2"	12	2"	12	2-1/2"	12	2-1/2"	6
1-3/4"	50	1-3/4"	25	2"	25	2-1/4"	12	2-1/4"	12	3"	12	3"	6
2"	50	2"	25	2-1/4"	12	2-1/2"	12	2-1/2"	12	3-1/2"	6	3-1/2"	6
2-1/4"	50	2-1/4"	25	2-1/2"	12	3"	12	3"	12	4"	6	4"	6
2-1/2"	50	2-1/2"	25	3"	12	3-1/2"	12	3-1/2"	12				
3"	50	3"	25	3-1/2"	12	4"	12	4"	12				

GARD (USS) F-911 Cap Screw Assortment

1,943 Piece Total including 2 Steel Bins

1/4" thru 1/2" / Coarse Thread / Part Number: 500-1CS

F-911 Alloy Hex Nuts and Flat Washers									
1/4"	Qty.	5/16"	Qty.	3/8"	Qty.	7/16"	Qty.	1/2"	Qty.
1/4-20 Hex Nut	100	5/16-18 Hex Nut	50	3/8-16 Hex Nut	50	7/16-14 Hex Nut	25	1/2-13 Hex Nut	25
1/4" Flatwasher	100	5/16" Flatwasher	100	3/8" Flatwasher	100	7/16" Flatwasher	100	1/2" Flatwasher	50

F-911 Cap Screws									
1/4-20 x	Qty.	5/16-18 x	Qty.	3/8-16 x	Qty.	7/16-14 x	Qty.	1/2-13 x	Qty.
1/2"	100	1/2"	50	3/4"	25	3/4"	25	3/4"	12
3/4"	100	3/4"	50	1"	25	1"	25	1"	12
1"	50	1"	50	1-1/4"	25	1-1/4"	12	1-1/4"	12
1-1/4"	50	1-1/4"	25	1-1/2"	25	1-1/2"	12	1-1/2"	12
1-1/2"	50	1-1/2"	25	1-3/4"	25	1-3/4"	12	1-3/4"	12
2"	50	1-3/4"	25	2"	25	2"	12	2"	12
2-1/2"	25	2"	25	2-1/2"	25	2-1/2"	12	2-1/2"	12
3"	25	2-1/2"	25	3"	25	3"	12	3"	12
		3"	25			3-1/2"	12	3-1/2"	12
		4"	25			4"	12	4"	12

GARD F-911 Alloy "Fine" Cap Screws

Hex Head / SAE



1/4 - 28 Fine

Length	Part No.	Pkg
1/2"	1-428-08	50
5/8"	1-428-10	50
3/4"	1-428-12	50
7/8"	1-428-14	50
1"	1-428-16	50
1-1/4"	1-428-20	50
1-1/2"	1-428-24	50
1-3/4"	1-428-28	50
2"	1-428-32	50
2-1/4"	1-428-36	50
2-1/2"	1-428-40	50
2-3/4"	1-428-44	50
3"	1-428-48	50
3-1/4"	1-428-52	25
3-1/2"	1-428-56	25
3-3/4"	1-428-60	25
4"	1-428-64	25
4-1/2"	1-428-72	1
5"	1-428-80	1
5-1/2"	1-428-88	1
6"	1-428-96	1
6-1/2"	1-428-104	1
7"	1-428-112	1
7-1/2"	1-428-120	1
8"	1-428-128	1

5/16 - 24 Fine

Length	Part No.	Pkg
1/2"	1-524-08	50
5/8"	1-524-10	50
3/4"	1-524-12	50
7/8"	1-524-14	50
1"	1-524-16	50
1-1/4"	1-524-20	50
1-1/2"	1-524-24	50
1-3/4"	1-524-28	50
2"	1-524-32	50
2-1/4"	1-524-36	50
2-1/2"	1-524-40	50
2-3/4"	1-524-44	50
3"	1-524-48	50
3-1/4"	1-524-52	25
3-1/2"	1-524-56	25
3-3/4"	1-524-60	25
4"	1-524-64	25
4-1/2"	1-524-72	1
5"	1-524-80	1
5-1/2"	1-524-88	1
6"	1-524-96	1
6-1/2"	1-524-104	1
7"	1-524-112	1
7-1/2"	1-524-120	1
8"	1-524-128	1

GARD F-911 Alloy "Fine" Cap Screws
Hex Head / SAE



3/8 - 24 Fine

7/16 - 20 Fine

Length	Part No.	Pkg
1/2"	1-624-08	50
5/8"	1-624-10	50
3/4"	1-624-12	50
7/8"	1-624-14	50
1"	1-624-16	50
1-1/4"	1-624-20	50
1-1/2"	1-624-24	50
1-3/4"	1-624-28	50
2"	1-624-32	50
2-1/4"	1-624-36	50
2-1/2"	1-624-40	50
2-3/4"	1-624-44	50
3"	1-624-48	50
3-1/4"	1-624-52	25
3-1/2"	1-624-56	25
3-3/4"	1-624-60	25
4"	1-624-64	25
4-1/2"	1-624-72	1
5"	1-624-80	1
5-1/2"	1-624-88	1
6"	1-624-96	1
6-1/2"	1-624-104	1
7"	1-624-112	1
7-1/2"	1-624-120	1
8"	1-624-128	1

Length	Part No.	Pkg
3/4"	1-720-12	25
7/8"	1-720-14	25
1"	1-720-16	25
1-1/4"	1-720-20	25
1-1/2"	1-720-24	25
1-3/4"	1-720-28	25
2"	1-720-32	25
2-1/4"	1-720-36	25
2-1/2"	1-720-40	25
2-3/4"	1-720-44	25
3"	1-720-48	25
3-1/4"	1-720-52	12
3-1/2"	1-720-56	12
3-3/4"	1-720-60	12
4"	1-720-64	12
4-1/2"	1-720-72	1
5"	1-720-80	1
5-1/2"	1-720-88	1
6"	1-720-96	1
6-1/2"	1-720-104	1
7"	1-720-112	1
7-1/2"	1-720-120	1
8"	1-720-128	1

GARD F-911 Alloy "Fine" Cap Screws Hex Head / SAE



1/2 - 20 Fine

Length	Part No.	Pkg
3/4"	1-820-12	25
7/8"	1-820-14	25
1"	1-820-16	25
1-1/4"	1-820-20	25
1-1/2"	1-820-24	25
1-3/4"	1-820-28	25
2"	1-820-32	25
2-1/4"	1-820-36	25
2-1/2"	1-820-40	25
2-3/4"	1-820-44	25
3"	1-820-48	25
3-1/4"	1-820-52	12
3-1/2"	1-820-56	12
3-3/4"	1-820-60	12
4"	1-820-64	12
4-1/2"	1-820-72	1
5"	1-820-80	1
5-1/2"	1-820-88	1
6"	1-820-96	1
6-1/2"	1-820-104	1
7"	1-820-112	1
7-1/2"	1-820-120	1
8"	1-820-128	1

9/16 - 18 Fine

Length	Part No.	Pkg
1"	1-918-16	12
1-1/4"	1-918-20	12
1-1/2"	1-918-24	12
1-3/4"	1-918-28	12
2"	1-918-32	12
2-1/4"	1-918-36	12
2-1/2"	1-918-40	12
2-3/4"	1-918-44	12
3"	1-918-48	12
3-1/4"	1-918-52	12
3-1/2"	1-918-56	12
3-3/4"	1-918-60	12
4"	1-918-64	12
4-1/2"	1-918-72	1
5"	1-918-80	1
5-1/2"	1-918-88	1
6"	1-918-96	1
6-1/2"	1-918-104	1
7"	1-918-112	1
7-1/2"	1-918-120	1
8"	1-918-128	1

GARD F-911 Alloy "Fine" Cap Screws

Hex Head / SAE



5/8 - 18 Fine

Length	Part No.	Pkg
1"	1-1018-16	6
1-1/4"	1-1018-20	6
1-1/2"	1-1018-24	6
1-3/4"	1-1018-28	6
2"	1-1018-32	6
2-1/4"	1-1018-36	6
2-1/2"	1-1018-40	6
2-3/4"	1-1018-44	6
3"	1-1018-48	6
3-1/4"	1-1018-52	6
3-1/2"	1-1018-56	6
3-3/4"	1-1018-60	6
4"	1-1018-64	6
4-1/2"	1-1018-72	1
5"	1-1018-80	1
5-1/2"	1-1018-88	1
6"	1-1018-96	1
6-1/2"	1-1018-104	1
7"	1-1018-112	1
7-1/2"	1-1018-120	1
8"	1-1018-128	1
8-1/2"	1-1018-136	1
9"	1-1018-144	1
9-1/2"	1-1018-152	1
10"	1-1018-160	1

3/4 - 16 Fine

Length	Part No.	Pkg
1"	1-1216-16	6
1-1/4"	1-1216-20	6
1-1/2"	1-1216-24	6
1-3/4"	1-1216-28	6
2"	1-1216-32	6
2-1/4"	1-1216-36	6
2-1/2"	1-1216-40	6
2-3/4"	1-1216-44	6
3"	1-1216-48	6
3-1/4"	1-1216-52	6
3-1/2"	1-1216-56	6
3-3/4"	1-1216-60	6
4"	1-1216-64	6
4-1/2"	1-1216-72	1
5"	1-1216-80	1
5-1/2"	1-1216-88	1
6"	1-1216-96	1
6-1/2"	1-1216-104	1
7"	1-1216-112	1
7-1/2"	1-1216-120	1
8"	1-1216-128	1
8-1/2"	1-1216-136	1
9"	1-1216-144	1
9-1/2"	1-1216-152	1
10"	1-1216-160	1

GARD F-911 Alloy "Fine" Cap Screws

Hex Head / SAE



7/8" - 14 Fine

Length	Part No.	Pkg
1-1/2"	1-1414-24	1
1-3/4"	1-1414-28	1
2"	1-1414-32	1
2-1/4"	1-1414-36	1
2-1/2"	1-1414-40	1
2-3/4"	1-1414-44	1
3"	1-1414-48	1
3-1/4"	1-1414-52	1
3-1/2"	1-1414-56	1
3-3/4"	1-1414-60	1
4"	1-1414-64	1
4-1/2"	1-1414-72	1
5"	1-1414-80	1
5-1/2"	1-1414-88	1
6"	1-1414-96	1
6-1/2"	1-1414-104	1
7"	1-1414-112	1
7-1/2"	1-1414-120	1
8"	1-1414-128	1
8-1/2"	1-1414-136	1
9"	1-1414-144	1
9-1/2"	1-1414-152	1
10"	1-1414-160	1

1" - 14 Fine

Length	Part No.	Pkg
1-1/2"	1-1614-24	1
1-3/4"	1-1614-28	1
2"	1-1614-32	1
2-1/4"	1-1614-36	1
2-1/2"	1-1614-40	1
2-3/4"	1-1614-44	1
3"	1-1614-48	1
3-1/4"	1-1614-52	1
3-1/2"	1-1614-56	1
3-3/4"	1-1614-60	1
4"	1-1614-64	1
4-1/2"	1-1614-72	1
5"	1-1614-80	1
5-1/2"	1-1614-88	1
6"	1-1614-96	1
6-1/2"	1-1614-104	1
7"	1-1614-112	1
7-1/2"	1-1614-120	1
8"	1-1614-128	1
8-1/2"	1-1614-136	1
9"	1-1614-144	1
9-1/2"	1-1614-152	1
10"	1-1614-160	1

GARD F-911 Alloy "Fine" Cap Screws

Hex Head / SAE



1-1/8" - 12 Fine

Length	Part No.	Pkg
2"	1-1812-32	1
2-1/4"	1-1812-36	1
2-1/2"	1-1812-40	1
2-3/4"	1-1812-44	1
3"	1-1812-48	1
3-1/4"	1-1812-52	1
3-1/2"	1-1812-56	1
3-3/4"	1-1812-60	1
4"	1-1812-64	1
4-1/2"	1-1812-72	1
5"	1-1812-80	1
5-1/2"	1-1812-88	1
6"	1-1812-96	1
6-1/2"	1-1812-104	1
7"	1-1812-112	1
7-1/2"	1-1812-120	1
8"	1-1812-128	1
8-1/2"	1-1812-136	1
9"	1-1812-144	1
9-1/2"	1-1812-152	1
10"	1-1812-160	1

1-1/4" - 12 Fine

Length	Part No.	Pkg
2"	1-2012-32	1
2-1/4"	1-2012-36	1
2-1/2"	1-2012-40	1
2-3/4"	1-2012-44	1
3"	1-2012-48	1
3-1/4"	1-2012-52	1
3-1/2"	1-2012-56	1
3-3/4"	1-2012-60	1
4"	1-2012-64	1
4-1/2"	1-2012-72	1
5"	1-2012-80	1
5-1/2"	1-2012-88	1
6"	1-2012-96	1
6-1/2"	1-2012-104	1
7"	1-2012-112	1
7-1/2"	1-2012-120	1
8"	1-2012-128	1
8-1/2"	1-2012-136	1
9"	1-2012-144	1
9-1/2"	1-2012-152	1
10"	1-2012-160	1

GARD (SAE) F-911 Cap Screw Assortment

1,447 Piece Total including 2 Steel Bins

1/4" thru 3/4" / Fine Thread / Part Number: 500-1F

F-911 Alloy Hex Nuts and Flat Washers

1/4"	Qty.	5/16"	Qty.	3/8"	Qty.	7/16"	Qty.	1/2"	Qty.	5/8"	Qty.	3/4"	Qty.
1/4-28 Hex Nut	50	5/16-24 Hex Nut	50	3/8-24 Hex Nut	50	7/16-20 Hex Nut	25	1/2-20 Hex Nut	25	5/8-18 Hex Nut	12	3/4-16 Hex Nut	12
1/4" Flatwasher	100	5/16" Flatwasher	100	3/8" Flatwasher	100	7/16" Flatwasher	50	1/2" Flatwasher	50	5/8" Flatwasher	25	3/4" Flatwasher	25

F-911 Cap Screws

1/4-28 x	Qty.	5/16-24 x	Qty.	3/8-24 x	Qty.	7/16-20 x	Qty.	1/2-20 x	Qty.	5/8-18 x	Qty.	3/4-16 x	Qty.
1/2"	50	1/2"	25	3/4"	12	1"	6	1"	6	1-1/2"	6	1-1/2"	6
3/4"	50	3/4"	25	1"	12	1-1/4"	6	1-1/4"	6	1-3/4"	6	1-3/4"	6
1"	25	1"	25	1-1/4"	12	1-1/2"	6	1-1/2"	6	2"	6	2"	6
1-1/4"	25	1-1/4"	12	1-1/2"	12	1-3/4"	6	1-3/4"	6	2-1/4"	6	2-1/4"	6
1-1/2"	25	1-1/2"	12	1-3/4"	12	2"	6	2"	6	2-1/2"	6	2-1/2"	6
1-3/4"	25	1-3/4"	12	2"	6	2-1/4"	6	2-1/4"	6	3"	6	3"	6
2"	25	2"	12	2-1/4"	6	2-1/2"	6	2-1/2"	6	3-1/2"	6	3-1/2"	6
2-1/4"	25	2-1/4"	12	2-1/2"	6	3"	6	3"	6	4"	6	4"	6
2-1/2"	25	2-1/2"	12	3"	6	3-1/2"	6	3-1/2"	6				
3"	25	3"	12	3-1/2"	6	4"	6	4"	6				

GARD (SAE) F-911 Cap Screw Assortment

962 Piece Total including 2 Steel Bins

1/4" thru 1/2" / Fine Thread / Part Number: 500-1FS

F-911 Alloy Hex Nuts and Flat Washers

1/4"	Qty.	5/16"	Qty.	3/8"	Qty.	7/16"	Qty.	1/2"	Qty.
1/4-28 Hex Nut	50	5/16-24 Hex Nut	25	3/8-24 Hex Nut	25	7/16-20 Hex Nut	12	1/2-20 Hex Nut	12
1/4" Flatwasher	50	5/16" Flatwasher	50	3/8" Flatwasher	50	7/16" Flatwasher	50	1/2" Flatwasher	25

F-911 Cap Screws

1/4-28 x	Qty.	5/16-24 x	Qty.	3/8-24 x	Qty.	7/16-20 x	Qty.	1/2-20 x	Qty.
1/2"	50	1/2"	25	3/4"	12	3/4"	12	3/4"	6
3/4"	50	3/4"	25	1"	12	1"	12	1"	6
1"	25	1"	25	1-1/4"	12	1-1/4"	6	1-1/4"	6
1-1/4"	25	1-1/4"	12	1-1/2"	12	1-1/2"	6	1-1/2"	6
1-1/2"	25	1-1/2"	12	1-3/4"	12	1-3/4"	6	1-3/4"	6
2"	25	1-3/4"	12	2"	12	2"	6	2"	6
2-1/2"	12	2"	12	2-1/2"	12	2-1/2"	6	2-1/2"	6
3"	12	2-1/2"	12	3"	12	3"	6	3"	6
		3"	12			3-1/2"	6	3-1/2"	6
		4"	12			4"	6	4"	6

HEAVY DUTY FASTENERS 17

GARD F-911 Alloy Cap Screw Assortment

984 Piece Total including Steel Bin

Part Number: 500-SK1C



Description	Qty.	Part No.
Hex Nuts 1/4-20	50	C-400-1N
USS Flats 1/4	100	U-400-1F
F-911 Cap Scev 1/4 x 1/2	25	1-420-08
F-911 Cap Scev 1/4 x 1	25	1-420-16
F-911 Cap Scev 1/4 x 1-1/2	25	1-420-24
F-911 Cap Scev 1/4 x 2	25	1-420-32
Hex Nuts 5/16-18	50	C-500-1N
USS Flats 5/16	100	U-500-1F
F-911 Cap Scev 5/16 x 1/2	25	1-518-08
F-911 Cap Scev 5/16 x 1	25	1-518-16
F-911 Cap Scev 5/16 x 1-1/2"	25	1-518-24
F-911 Cap Scev 5/16 x 2	25	1-518-32
Hex Nuts 3/8-16	50	C-600-1N
USS Flats 3/8	100	U-600-1F
F-911 Cap Scev 3/8 x 1	25	1-616-16
F-911 Cap Scev 3/8 x 1-1/2	25	1-616-24
F-911 Cap Scev 3/8 x 2	25	1-616-32
F-911 Cap Scev 3/8 x 2-1/2	12	1-616-40

Description	Qty.	Part No.
Hex Nuts 7/16-14	25	C-700-1N
USS Flats 7/16	50	U-700-1F
F-911 Cap Screw 7/16 x 1	12	1-714-16
F-911 Cap Screw 7/16 x 1-1/2	12	1-714-24
F-911 Cap Screw 7/16 x 2	12	1-714-32
F-911 Cap Screw 7/16 x 2-1/2	12	1-714-40
Hex Nuts 1/2-13	25	C-800-1N
USS Flats 1/2	50	U-800-1F
F-911 Cap Screw 1/2 x 1	12	1-813-16
F-911 Cap Screw 1/2 x 1-1/2	12	1-813-24
F-911 Cap Screw 1/2 x 2	12	1-813-32
F-911 Cap Screw 1/2 x 2-1/2	12	1-813-40

**Assortment Designed for
America's Machinist
Made and Assembled in the USA**

GARD F-911 USS Alloy Hex Nuts

Size	Part Number	Pkg
1/4-20	C-400-1N	250
5/16-18	C-500-1N	250
3/8-16	C-600-1N	250
7/16-14	C-700-1N	100
1/2-13	C-800-1N	100
9/16-12	C-900-1N	50
5/8-11	C-1000-1N	50
3/4-10	C-1200-1N	50
7/8-9	C-1400-1N	25
1"-8	C-1600-1N	25
1-1/8"-7	C-1800-1N	10
1-1/4"-7	C-2000-1N	10



GARD F-911 SAE Alloy Hex Nuts

Size	Part Number	Pkg
1/4-28	F-400-1N	250
5/16-24	F-500-1N	250
3/8-24	F-600-1N	250
7/16-20	F-700-1N	100
1/2-20	F-800-1N	100
9/16-18	F-900-1N	50
5/8-18	F-1000-1N	50
3/4-16	F-1200-1N	50
7/8-14	F-1400-1N	25
1"-14	F-1600-1N	25
1-1/8"-12	F-1800-1N	10
1-1/4"-12	F-2000-1N	10



GARD F-911 USS Alloy Flat Washers

Q. What's the difference between USS and SAE flat washers?

A. Outside Diameter (O.D)



Size	O.D.	Part Number	Pkg
1/4"	3/4"	U-400-1F	250
5/16"	7/8"	U-500-1F	250
3/8"	1"	U-600-1F	250
7/16"	1-1/4"	U-700-1F	100
1/2"	1-3/8"	U-800-1F	100
9/16"	1-1/2"	U-900-1F	50
5/8"	1-3/4"	U-1000-1F	50
3/4"	2"	U-1200-1F	50
7/8"	2-1/4"	U-1400-1F	25
1"	2-1/2"	U-1600-1F	25
1-1/8"	2-3/4"	U-1800-1F	25
1-1/4"	3"	U-2000-1F	25

Size	O.D.	Thickness	Part Number	Pkg
1/4"	5/8"	1/16"	S-400-1F	250
5/16"	11/16"	1/16"	S-500-1F	250
3/8"	13/16"	1/16"	S-600-1F	250
7/16"	15/16"	1/16"	S-700-1F	100
1/2"	1-1/16"	3/32"	S-800-1F	100
9/16"	1-3/16"	3/32"	S-900-1F	50
5/8"	1-5/16"	3/32"	S-1000-1F	50
3/4"	1-1/2"	1/8"	S-1200-1F	50
7/8"	1-3/4"	1/8"	S-1400-1F	25
1"	2"	1/8"	S-1600-1F	25
1-1/8"	2-1/4"	1/8"	S-1800-1F	25
1-1/4"	2-1/2"	1/8"	S-2000-1F	25

GARD F-911 SAE Alloy Flat Washers



Size	O.D.	Thickness	Part Number	Pkg
1/4"	5/8"	3/32"	S-400-1FH	100
5/16"	11/16"	3/32"	S-500-1FH	100
3/8"	13/16"	7/64"	S-600-1FH	100
7/16"	15/16"	13/64"	S-700-1FH	100
1/2"	1-1/16"	13/64"	S-800-1FH	100
5/8"	1-5/16"	1/4"	S-1000-1FH	50
3/4"	1-1/2"	1/4"	S-1200-1FH	50
7/8"	1-3/4"	1/4"	S-1400-1FH	25
1"	2"	1/4"	S-1600-1FH	25

GARD F-911 SAE Heavy Flat Washers



GARD F-911 Alloy Lock Washers

Size	Part Number	Pkg
1/4"	400-1L	250
5/16"	500-1L	250
3/8"	600-1L	250
7/16"	700-1L	100
1/2"	800-1L	100
9/16"	900-1L	50
5/8"	1000-1L	50
3/4"	1200-1L	50
7/8"	1400-1L	25
1"	1600-1L	25
1-1/8"	1800-1L	25



GARD USS Alloy Lock Nuts



Size	Part Number	Pkg
1/4-20	C-400-1LN	100
5/16-18	C-500-1LN	100
3/8-16	C-600-1LN	100
7/16-14	C-700-1LN	100
1/2-13	C-800-1LN	100
9/16-12	C-900-1LN	50
5/8-11	C-1000-1LN	50
3/4-10	C-1200-1LN	25
7/8-9	C-1400-1LN	25
1"-8	C-1600-1LN	25
1-1/8"-7	C-1800-1LN	10
1-1/4"-7	C-2000-1LN	10

GARD SAE Alloy Lock Nuts



Size	Part Number	Pkg
1/4-28	F-400-1LN	100
5/16-24	F-500-1LN	100
3/8-24	F-600-1LN	100
7/16-20	F-700-1LN	100
1/2-20	F-800-1LN	100
9/16-18	F-900-1LN	50
5/8-18	F-1000-1LN	50
3/4-16	F-1200-1LN	25
7/8-14	F-1400-1LN	25
1"-14	F-1600-1LN	25
1-1/8"-12	F-1800-1LN	10
1-1/4"-12	F-2000-1LN	10

Direct-Lock Washer

Specifically designed to solve the problem of fastener failure.
Preassembled in glued pairs for ease of installation.



Preassembled Glued Pairs

- Heavy duty structural self-locking fastener which prevents loosening caused by shock or vibration in high stress applications
- It has outperformed all other types of loose, washered, threaded or pinned fixings in heavy-duty vibration applications
- Protective coating is tested under 600 hours of salt spray

Direct-Lock Heavy Hex Nut

The ideal vibration proof locking solution for large, pressurized applications.



- Free spinning, vibration and shock proof lock nut
- Used in high stress, vibration sensitive areas, and in safety critical applications
- Eliminates equipment downtime
- Reduces maintenance costs
- Increases productivity
- Enhances safety

Who uses the Direct-Lock Heavy Hex Nut and Washers?

- Automotive Industries (cars, trucks, buses)
- Heavy Equipment (road and construction)
- Logging Equipment
- Military Equipment
- Mining Equipment
- Oil Drilling Rigs
- Pile Hammers
- Pipelines
- Public Utilities
- Railroads
- Rapid Transit Systems
- Refineries
- Wind Turbines
- Lug Nuts

continued

Direct-Lock Washer and Heavy Hex Nut Assortment

25 pcs. each, in adjustable steel tray

Part Number: 500-DLN

Lock Washer Size	Part No.	Lock Nut Size	Part No.	Pkg. Qty.
1/4"	400-1DL			25
5/16"	500-1DL			25
3/8"	600-1DL	3/8-16	616-DLN	25
7/16"	700-1DL			25
1/2"	800-1DL	1/2-13	813-DLN	25
9/16"	900-1DL			25
5/8"	1000-1DL	5/8-11	1011-DLN	25
3/4"	1200-1DL			25

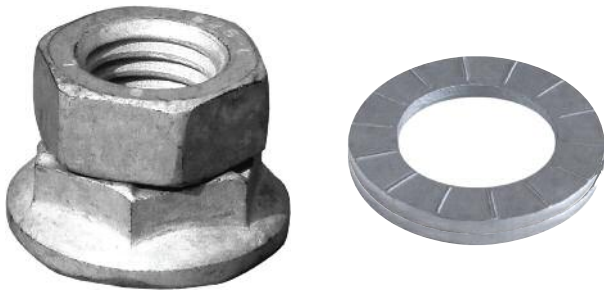

Probably the most effective locking device in the world for maintaining joint integrity.



Nylon Lock Nuts



USS Nylon Lock Nuts

Size	Part Number	Pkg
1/4-20	C-400-2NLN	100
5/16-18	C-500-2NLN	100
3/8-16	C-600-2NLN	100
7/16-14	C-700-2NLN	100
1/2-13	C-800-2NLN	100
9/16-12	C-900-2NLN	50
5/8-11	C-1000-2NLN	50
3/4-10	C-1200-2NLN	25
7/8-9	C-1400-2NLN	10
1"-8	C-1600-2NLN	10

SAE Nylon Lock Nuts

Size	Part Number	Pkg
1/4-28	F-400-2NLN	100
5/16-24	F-500-2NLN	100
3/8-24	F-600-2NLN	100
7/16-20	F-700-2NLN	100
1/2-20	F-800-2NLN	100
9/16-18	F-900-2NLN	50
5/8-18	F-1000-2NLN	50
3/4-16	F-1200-2NLN	25
7/8-14	F-1400-2NLN	10
1"-14	F-1600-2NLN	10

All Black — USS Coarse Plow Screw Hex Nuts



Size	Part Number	Pkg
5/8-11	C-1000-13N	25
3/4-10	C-1200-13N	20
7/8-9	C-1400-13N	15
1"-8	C-1600-13N	10
1-1/4"-7	C-2000-13N	6

GARD F-911 Dome Head Plow Screws

All Black Plow Screws



5/8 - 11 Coarse

Length	Part No.	Pkg
1-3/4"	13-1011-28	1
2"	13-1011-32	1
2-1/4"	13-1011-36	1
2-1/2"	13-1011-40	1
2-3/4"	13-1011-44	1
3"	13-1011-48	1
3-1/2"	13-1011-56	1
4"	13-1011-64	1
5"	13-1011-80	1

7/8 - 9 Coarse

Length	Part No.	Pkg
2-1/2"	13-1409-40	1
2-3/4"	13-1409-44	1
3"	13-1409-48	1
3-1/4"	13-1409-52	1
3-1/2"	13-1409-56	1
4"	13-1409-64	1
4-1/2"	13-1409-72	1
5"	13-1409-80	1

3/4 - 10 Coarse

Length	Part No.	Pkg
2"	13-1210-32	1
2-1/4"	13-1210-36	1
2-1/2"	13-1210-40	1
2-3/4"	13-1210-44	1
3"	13-1210-48	1
3-1/4"	13-1210-52	1
3-1/2"	13-1210-56	1
3-3/4"	13-1210-60	1
4"	13-1210-64	1
4-1/2"	13-1210-72	1
5"	13-1210-80	1
6"	13-1210-96	1

1 - 8 Coarse

Length	Part No.	Pkg
2-1/2"	13-1608-40	1
2-3/4"	13-1608-44	1
3"	13-1608-48	1
3-1/4"	13-1608-52	1
3-1/2"	13-1608-56	1
3-3/4"	13-1608-60	1
4"	13-1608-64	1
4-1/2"	13-1608-72	1
5"	13-1608-80	1
5-1/2"	13-1608-88	1
6"	13-1608-96	1

1-1/4 - 7 Coarse

Length	Part No.	Pkg
3-3/4"	13-2007-60	1
4"	13-2007-64	1
4-1/2"	13-2007-72	1
5"	13-2007-80	1

GARD F-911 Shaker Screen Screws

Gold Dichromate



1/2 - 13 Coarse

Length	Part No.	Pkg
1-1/2"	14-813-24	1
2"	14-813-32	1
2-1/2"	14-813-40	1
3"	14-813-48	1
3-1/2"	14-813-56	1
4"	14-813-64	1
4-1/2"	14-813-72	1
5"	14-813-80	1
6"	14-813-96	1

5/8 - 11 Coarse

Length	Part No.	Pkg
2"	14-1011-32	1
2-1/2"	14-1011-40	1
3"	14-1011-48	1
3-1/2"	14-1011-56	1
4"	14-1011-64	1
4-1/2"	14-1011-72	1
5"	14-1011-80	1
5-1/2"	14-1011-88	1
6"	14-1011-96	1

3/4 - 10 Coarse

Length	Part No.	Pkg
3"	14-1210-48	1
3-1/2"	14-1210-56	1
4"	14-1210-64	1
4-1/2"	14-1210-72	1
5"	14-1210-80	1
5-1/2"	14-1210-88	1
6"	14-1210-96	1

Hex	Part No.	Pkg
1/16"	5671-01	1
5/64"	5671-013	1
3/32"	5671-015	1
7/64"	5671-018	1
1/8"	5671-02	1
9/64"	5671-023	1
5/32"	5671-025	1
3/16"	5671-03	1
7/32"	5671-035	1
1/4"	5671-04	1
5/16"	5671-05	1
3/8"	5671-06	1

Alloy Hex Keys

Short Series

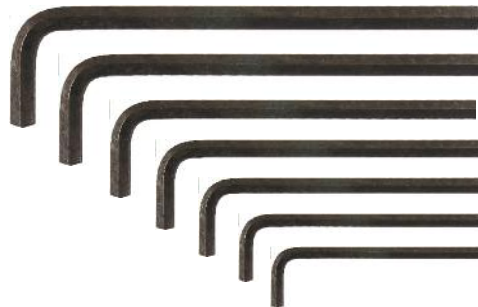

Alloy Socket Head Cap Screws

Machine Screw Sizes / Solid Black



#2-56

Length	Part No.	Pkg
3/16"	256-3-3	50
1/4"	256-4-3	50
3/8"	256-6-3	50
1/2"	256-8-3	50

#3-48

Length	Part No.	Pkg
3/16"	348-3-3	50
1/4"	348-4-3	50
3/8"	348-6-3	50
1/2"	348-8-3	50

#4-40

Length	Part No.	Pkg
1/4"	440-4-3	50
3/8"	440-6-3	50
1/2"	440-8-3	50
5/8"	440-10-3	50
3/4"	440-12-3	50

#5-40

Length	Part No.	Pkg
1/4"	540-4-3	50
3/8"	540-6-3	50
1/2"	540-8-3	50
5/8"	540-10-3	50
3/4"	540-12-3	50

#6-32

Length	Part No.	Pkg
1/4"	632-4-3	50
3/8"	632-6-3	50
1/2"	632-8-3	50
5/8"	632-10-3	50
3/4"	632-12-3	50
7/8"	632-14-3	50
1"	632-16-3	50

#8-32

Length	Part No.	Pkg
1/4"	832-4-3	50
3/8"	832-6-3	50
1/2"	832-8-3	50
5/8"	832-10-3	50
3/4"	832-12-3	50
7/8"	832-14-3	50
1"	832-16-3	50
1-1/4"	832-20-3	50
1-1/2"	832-24-3	50
1-3/4"	832-28-3	50
2"	832-32-3	50

#10-24

Length	Part No.	Pkg
1/4"	1024-4-3	50
3/8"	1024-6-3	50
1/2"	1024-8-3	50
5/8"	1024-10-3	50
3/4"	1024-12-3	50
7/8"	1024-14-3	50
1"	1024-16-3	50
1-1/4"	1024-20-3	50
1-1/2"	1024-24-3	50
1-3/4"	1024-28-3	50
2"	1024-32-3	50

#10-32

Length	Part No.	Pkg
1/4"	1032-4-3	50
3/8"	1032-6-3	50
1/2"	1032-8-3	50
5/8"	1032-10-3	50
3/4"	1032-12-3	50
7/8"	1032-14-3	50
1"	1032-16-3	50
1-1/4"	1032-20-3	50
1-1/2"	1032-24-3	50
1-3/4"	1032-28-3	50
2"	1032-32-3	50

HEAVY DUTY FASTENERS 27

Alloy Socket Head Cap Screws

USS Coarse Sizes / Solid Black



1/4-20

Length	Part No.	Pkg
1/4"	C-404-3	50
3/8"	C-406-3	50
1/2"	C-408-3	50
5/8"	C-410-3	50
3/4"	C-412-3	50
7/8"	C-414-3	50
1"	C-416-3	50
1-1/4"	C-420-3	50
1-1/2"	C-424-3	50
1-3/4"	C-428-3	50
2"	C-432-3	50
2-1/4"	C-436-3	50
2-1/2"	C-440-3	50
2-3/4"	C-444-3	50
3"	C-448-3	50
4"	C-464-3	50

5/16-18 (cont.)

Length	Part No.	Pkg
3"	C-548-3	50
3-1/4"	C-552-3	50
3-1/2"	C-556-3	50
4"	C-564-3	50

7/16-14

Length	Part No.	Pkg
3/4"	C-712-3	25
7/8"	C-714-3	25
1"	C-716-3	25
1-1/4"	C-720-3	25
1-1/2"	C-724-3	25
1-3/4"	C-728-3	25
2"	C-732-3	25
2-1/4"	C-736-3	25
2-1/2"	C-740-3	25
2-3/4"	C-744-3	25
3"	C-748-3	25
3-1/2"	C-756-3	25
4"	C-764-3	25

3/8-16

Length	Part No.	Pkg
1/2"	C-608-3	25
5/8"	C-610-3	25
3/4"	C-612-3	25
7/8"	C-614-3	25
1"	C-616-3	25
1-1/4"	C-620-3	25
1-1/2"	C-624-3	25
1-3/4"	C-628-3	25
2"	C-632-3	25
2-1/4"	C-636-3	25
2-1/2"	C-640-3	25
2-3/4"	C-644-3	25
3"	C-648-3	25
3-1/4"	C-652-3	25
3-1/2"	C-656-3	25
4"	C-664-3	25
4-1/2"	C-672-3	1
5"	C-680-3	1
6"	C-696-3	1

1/2-13

Length	Part No.	Pkg
1/2"	C-808-3	25
3/4"	C-812-3	25
7/8"	C-814-3	25
1"	C-816-3	25
1-1/4"	C-820-3	25
1-1/2"	C-824-3	25
1-3/4"	C-828-3	25
2"	C-832-3	25
2-1/4"	C-836-3	25
2-1/2"	C-840-3	25
2-3/4"	C-844-3	25
3"	C-848-3	25
3-1/4"	C-852-3	25
3-1/2"	C-856-3	25
4"	C-864-3	25
4-1/2"	C-872-3	1
5"	C-880-3	1
6"	C-896-3	1

5/16-18

Length	Part No.	Pkg
3/8"	C-506-3	50
1/2"	C-508-3	50
5/8"	C-510-3	50
3/4"	C-512-3	50
7/8"	C-514-3	50
1"	C-516-3	50
1-1/4"	C-520-3	50
1-1/2"	C-524-3	50
1-3/4"	C-528-3	50
2"	C-532-3	50
2-1/4"	C-536-3	50
2-1/2"	C-540-3	50
2-3/4"	C-544-3	50

Alloy Socket Head Cap Screws

USS Coarse Sizes / Solid Black



5/8-11

Length	Part No.	Pkg
1"	C-1016-3	25
1-1/4"	C-1020-3	25
1-1/2"	C-1024-3	25
1-3/4"	C-1028-3	25
2"	C-1032-3	25
2-1/4"	C-1036-3	25
2-1/2"	C-1040-3	25
2-3/4"	C-1044-3	25
3"	C-1048-3	25
3-1/4"	C-1052-3	25
3-1/2"	C-1056-3	25
4"	C-1064-3	25
4-1/2"	C-1072-3	1
5"	C-1080-3	1
5-1/2"	C-1088-3	1
6"	C-1096-3	1

7/8-9

Length	Part No.	Pkg
2"	C-1432-3	10
2-1/4"	C-1436-3	10
2-1/2"	C-1440-3	10
2-3/4"	C-1444-3	10
3"	C-1448-3	10
3-1/4"	C-1452-3	10
3-1/2"	C-1456-3	10
4"	C-1464-3	10
4-1/2"	C-1472-3	1
5"	C-1480-3	1
5-1/2"	C-1488-3	1
6"	C-1496-3	1
6-1/2"	C-14104-3	1
7"	C-14112-3	1
8"	C-14128-3	1

3/4-10

Length	Part No.	Pkg
1-1/4"	C-1220-3	25
1-1/2"	C-1224-3	25
1-3/4"	C-1228-3	25
2"	C-1232-3	25
2-1/4"	C-1236-3	25
2-1/2"	C-1240-3	25
2-3/4"	C-1244-3	25
3"	C-1248-3	25
3-1/4"	C-1252-3	25
3-1/2"	C-1256-3	25
4"	C-1264-3	25
4-1/2"	C-1272-3	1
5"	C-1280-3	1
5-1/2"	C-1288-3	1
6"	C-1296-3	1

1-8

Length	Part No.	Pkg
2"	C-1632-3	10
2-1/4"	C-1636-3	10
2-1/2"	C-1640-3	10
2-3/4"	C-1644-3	10
3"	C-1648-3	10
3-1/4"	C-1652-3	10
3-1/2"	C-1656-3	10
4"	C-1664-3	10
4-1/2"	C-1672-3	1
5"	C-1680-3	1
5-1/2"	C-1688-3	1
6"	C-1696-3	1
6-1/2"	C-16104-3	1
7"	C-16112-3	1
8"	C-16128-3	1

Alloy Socket Flat Head Cap Screws

Machine Screw Sizes / USS Coarse Sizes / Solid Black



Machine Screw

#4-40

Length	Part No.	Pkg
1/4"	440-4-4	50
3/8"	440-6-4	50
1/2"	440-8-4	50
5/8"	440-10-4	50
3/4"	440-12-4	50

#5-40

Length	Part No.	Pkg
1/4"	540-4-4	50
3/8"	540-6-4	50
1/2"	540-8-4	50
5/8"	540-10-4	50
3/4"	540-12-4	50

#6-32

Length	Part No.	Pkg
1/4"	632-4-4	50
3/8"	632-6-4	50
1/2"	632-8-4	50
5/8"	632-10-4	50
3/4"	632-12-4	50

#8-32

Length	Part No.	Pkg
3/8"	832-6-4	50
1/2"	832-8-4	50
5/8"	832-10-4	50
3/4"	832-12-4	50
1"	832-16-4	50

#10-24

Length	Part No.	Pkg
3/8"	1024-6-4	50
1/2"	1024-8-4	50
5/8"	1024-10-4	50
3/4"	1024-12-4	50
1"	1024-16-4	50
1-1/4"	1024-20-4	50

#10-32

Length	Part No.	Pkg
3/8"	1032-6-4	50
1/2"	1032-8-4	50
5/8"	1032-10-4	50
3/4"	1032-12-4	50
1"	1032-16-4	50
1-1/4"	1032-20-4	50
1-1/2"	1032-24-4	50

USS Coarse

1/4-20

Length	Part No.	Pkg
3/8"	C-406-4	50
1/2"	C-408-4	50
5/8"	C-410-4	50
3/4"	C-412-4	50
1"	C-416-4	50
1-1/4"	C-420-4	50
1-1/2"	C-424-4	50
1-3/4"	C-428-4	50
2"	C-432-4	50

5/16-18

Length	Part No.	Pkg
1/2"	C-508-4	50
5/8"	C-510-4	50
3/4"	C-512-4	50
1"	C-516-4	50
1-1/4"	C-520-4	50
1-1/2"	C-524-4	50
1-3/4"	C-528-4	50
2"	C-532-4	50
2-1/4"	C-536-4	50
2-1/2"	C-540-4	50

3/8-16

Length	Part No.	Pkg
1/2"	C-608-4	25
5/8"	C-610-4	25
3/4"	C-612-4	25
1"	C-616-4	25
1-1/4"	C-620-4	25
1-1/2"	C-624-4	25
1-3/4"	C-628-4	25
2"	C-632-4	25
2-1/4"	C-636-4	25
2-1/2"	C-640-4	25
3"	C-648-4	25

Alloy Socket Flat Head Cap Screws

Machine Screw Sizes / USS Coarse Sizes / Solid Black



USS Coarse (cont.)

7/16-14

Length	Part No.	Pkg
3/4"	C-712-4	25
1"	C-716-4	25
1-1/4"	C-720-4	25
1-1/2"	C-724-4	25

5/8-11

Length	Part No.	Pkg
1-1/4"	C-1020-4	25
1-1/2"	C-1024-4	25
1-3/4"	C-1028-4	25
2"	C-1032-4	25
2-1/4"	C-1036-4	25
2-1/2"	C-1040-4	25
3"	C-1048-4	25

1/2-13

Length	Part No.	Pkg
3/4"	C-812-4	25
1"	C-816-4	25
1-1/4"	C-820-4	25
1-1/2"	C-824-4	25
1-3/4"	C-828-4	25
2"	C-832-4	25
2-1/4"	C-836-4	25
2-1/2"	C-840-4	25
3"	C-848-4	25

3/4-10

Length	Part No.	Pkg
1-1/2"	C-1224-4	25
1-3/4"	C-1228-4	25
2"	C-1232-4	25
2-1/2"	C-1240-4	25
3"	C-1248-4	25

Alloy Hex Set Screws - Cup Point

Machine Screw Sizes / USS Cup Point



#4-40

Length	Part No.	Pkg
3/16"	440-3-6	50
1/4"	440-4-6	50
5/16"	440-5-6	50
3/8"	440-6-6	50
1/2"	440-8-6	50

#5-40

Length	Part No.	Pkg
1/8"	540-2-6	50
3/16"	540-3-6	50
1/4"	540-4-6	50
5/16"	540-5-6	50
3/8"	540-6-6	50

#5-40 (cont.)

Length	Part No.	Pkg
1/2"	540-8-6	50
5/8"	540-10-6	50
3/4"	540-12-6	50

continued

HEAVY DUTY FASTENERS 31

Alloy Hex Set Screws - Cup Point

Machine Screw Sizes / USS Cup Point



#6-32 / Machine

Length	Part No.	Pkg
1/8"	632-2-6	50
3/16"	632-3-6	50
1/4"	632-4-6	50
5/16"	632-5-6	50
3/8"	632-6-6	50
1/2"	632-8-6	50
5/8"	632-10-6	50
3/4"	632-12-6	50
1"	632-16-6	50

#10-32 / Machine

Length	Part No.	Pkg
3/16"	1032-3-6	50
1/4"	1032-4-6	50
5/16"	1032-5-6	50
3/8"	1032-6-6	50
1/2"	1032-8-6	50
5/8"	1032-10-6	50
3/4"	1032-12-6	50
1"	1032-16-6	50

5/16-18 / USS cont.

Length	Part No.	Pkg
3/4"	C-512-6	50
7/8"	C-514-6	50
1"	C-516-6	50
1-1/4"	C-520-6	50
1-1/2"	C-524-6	50
1-3/4"	C-528-6	50
2"	C-532-6	50

#8-32 / Machine

Length	Part No.	Pkg
1/8"	832-2-6	50
3/16"	832-3-6	50
1/4"	832-4-6	50
5/16"	832-5-6	50
3/8"	832-6-6	50
7/16"	832-7-6	50
1/2"	832-8-6	50
5/8"	832-10-6	50
3/4"	832-12-6	50
1"	832-16-6	50

1/4-20 / USS

Length	Part No.	Pkg
3/16"	C-403-6	50
1/4"	C-404-6	50
5/16"	C-405-6	50
3/8"	C-406-6	50
7/16"	C-407-6	50
1/2"	C-408-6	50
5/8"	C-410-6	50
3/4"	C-412-6	50
7/8"	C-414-6	50
1"	C-416-6	50
1-1/4"	C-420-6	50
1-1/2"	C-424-6	50
1-3/4"	C-428-6	50
2"	C-432-6	50

3/8-16 / USS

Length	Part No.	Pkg
1/4"	C-604-6	25
5/16"	C-605-6	25
3/8"	C-606-6	25
7/16"	C-607-6	25
1/2"	C-608-6	25
5/8"	C-610-6	25
3/4"	C-612-6	25
7/8"	C-614-6	25
1"	C-616-6	25
1-1/4"	C-620-6	25
1-1/2"	C-624-6	25
1-3/4"	C-628-6	25
2"	C-632-6	25
2-1/2"	C-640-6	25

#10-24 / Machine

Length	Part No.	Pkg
3/16"	1024-3-6	50
1/4"	1024-4-6	50
5/16"	1024-5-6	50
3/8"	1024-6-6	50
1/2"	1024-8-6	50
5/8"	1024-10-6	50
3/4"	1024-12-6	50
7/8"	1024-14-6	50
1"	1024-16-6	50

5/16-18 / USS

Length	Part No.	Pkg
1/4"	C-504-6	50
5/16"	C-505-6	50
3/8"	C-506-6	50
7/16"	C-507-6	50
1/2"	C-508-6	50
5/8"	C-510-6	50

7/16-14 / USS

Length	Part No.	Pkg
3/8"	C-706-6	25
7/16"	C-707-6	25
1/2"	C-708-6	25
5/8"	C-710-6	25
3/4"	C-712-6	25
7/8"	C-714-6	25
1"	C-716-6	25
1-1/4"	C-720-6	25

Alloy Hex Set Screws - Cup Point

Machine Screw Sizes / USS Cup Point



1/2-13

Length	Part No.	Pkg
3/8"	C-806-6	25
1/2"	C-808-6	25
5/8"	C-810-6	25
3/4"	C-812-6	25
7/8"	C-814-6	25
1"	C-816-6	25
1-1/4"	C-820-6	25
1-1/2"	C-824-6	25
1-3/4"	C-828-6	25
2"	C-832-6	25
2-1/2"	C-840-6	25
3"	C-848-6	25

Alloy Hex Set Screws - Cup Point Assortment

Machine Screw Sizes / USS Coarse
601 Piece Total including 24-hole Tray
Part Number: 500-6



#6-32 x	1/4, 3/8, 1/2"	25 each
#8-32 x	1/4, 3/8, 1/2"	25 each
#10-24 x	1/4, 3/8, 1/2"	25 each
#10-32 x	1/4, 3/8, 1/2"	25 each
1/4-20 x	1/4, 3/8, 1/2"	25 each
5/16-18 x	1/4, 3/8, 1/2"	25 each
3/8-16 x	1/4, 3/8, 1/2"	25 each
1/2-13 x	1/2, 3/4, 1"	25 each

Alloy Hex Set Screws - Cup Point

Machine Screw Sizes / SAE Cup Point

1/4-28

Length	Part No.	Pkg
3/16"	F-403-6	25
1/4"	F-404-6	25
5/16"	F-405-6	25
3/8"	F-406-6	25
7/16"	F-407-6	25
1/2"	F-408-6	25
5/8"	F-410-6	25
3/4"	F-412-6	25
1"	F-416-6	25
1-1/4"	F-420-6	25



5/16-24 (cont.)

Length	Part No.	Pkg
5/8"	F-510-6	25
3/4"	F-512-6	25
1"	F-516-6	25
1-1/2"	F-524-6	25

3/8-24 (cont.)

Length	Part No.	Pkg
3/4"	F-612-6	25
1"	F-616-6	25
1-1/4"	F-620-6	25
1-1/2"	F-624-6	25

7/16-20

Length	Part No.	Pkg
3/8"	F-706-6	25
7/16"	F-707-6	25
1/2"	F-708-6	25

5/16-24

Length	Part No.	Pkg
1/4"	F-504-6	25
5/16"	F-505-6	25
3/8"	F-506-6	25
1/2"	F-508-6	25

3/8-24

Length	Part No.	Pkg
1/4"	F-604-6	25
5/16"	F-605-6	25
3/8"	F-606-6	25
7/16"	F-607-6	25
1/2"	F-608-6	25
5/8"	F-610-6	25

1/2-20

Length	Part No.	Pkg
1/2"	F-808-6	25
5/8"	F-810-6	25
3/4"	F-812-6	25
1"	F-816-6	25

HEAVY DUTY FASTENERS 33

Round Head / Square Neck Carriage Bolts



1/4-20

Length	Part No.	Pkg
3/4"	C-412-9	50
1"	C-416-9	50
1-1/4"	C-420-9	50
1-1/2"	C-424-9	50
1-3/4"	C-428-9	50
2"	C-432-9	50
2-1/4"	C-436-9	50
2-1/2"	C-440-9	50
2-3/4"	C-444-9	50
3"	C-448-9	50
3-1/4"	C-452-9	50
3-1/2"	C-456-9	50
4"	C-464-9	50
4-1/2"	C-472-9	1
5"	C-480-9	1
5-1/2"	C-488-9	1
6"	C-496-9	1
6-1/2"	C-4104-9	1
7"	C-4112-9	1
8"	C-4128-9	1

5/16-18 cont.

Length	Part No.	Pkg
3-1/2"	C-556-9	50
4"	C-564-9	50
4-1/2"	C-572-9	1
5"	C-580-9	1
5-1/2"	C-588-9	1
6"	C-596-9	1
6-1/2"	C-5104-9	1
7"	C-5112-9	1
8"	C-5128-9	1

1/2-13

Length	Part No.	Pkg
1-1/4"	C-820-9	50
1-1/2"	C-824-9	50
1-3/4"	C-828-9	50
2"	C-832-9	50
2-1/4"	C-836-9	25
2-1/2"	C-840-9	25
3"	C-848-9	25
3-1/2"	C-856-9	25
4"	C-864-9	25
4-1/2"	C-872-9	1
5"	C-880-9	1
5-1/2"	C-888-9	1
6"	C-896-9	1
6-1/2"	C-8104-9	1
7"	C-8112-9	1
7-1/2"	C-8120-9	1
8"	C-8128-9	1

3/8-16

Length	Part No.	Pkg
3/4"	C-612-9	50
1"	C-616-9	50
1-1/4"	C-620-9	50
1-1/2"	C-624-9	50
1-3/4"	C-628-9	50
2"	C-632-9	50
2-1/4"	C-636-9	50
2-1/2"	C-640-9	50
2-3/4"	C-644-9	50
3"	C-648-9	50
3-1/4"	C-652-9	50
3-1/2"	C-656-9	50
4"	C-664-9	50
4-1/2"	C-672-9	1
5"	C-680-9	1
5-1/2"	C-688-9	1
6"	C-696-9	1
6-1/2"	C-6104-9	1
7"	C-6112-9	1
7-1/2"	C-6120-9	1

5/16-18

Length	Part No.	Pkg
3/4"	C-512-9	50
1"	C-516-9	50
1-1/4"	C-520-9	50
1-1/2"	C-524-9	50
1-3/4"	C-528-9	50
2"	C-532-9	50
2-1/4"	C-536-9	50
2-1/2"	C-540-9	50
2-3/4"	C-544-9	50
3"	C-548-9	50
3-1/4"	C-552-9	50